

# For Sale

**NAI 1st Valley**  
Commercial Real Estate Services, Worldwide.

Fixer Upper

\$120,000



## 16065 US-70

Organ, NM 88052

### Offering Summary

Sale Price	\$120,000
Lot Size	0.95 Acres
Number of Buildings	2
Zoning	T4

### Property Highlights

- Situated right off of HWY 70 at the base of the Organ Mountains
- Zoned Commercial & Residential
- Mechanics area on site
- Can be repurposed for many uses
- Sold "As Is"
- Owner Financing is possible

For more information:

**Preston Williams**

O: 575.521.1535 C: 575.621.2445  
preston@1stvalley.com

We obtained the information above from sources we believe to be reliable. However, we have not verified its accuracy and make no guarantee, warranty or representation about it. It is submitted subject to the possibility of errors, omissions, change of price, rental or other conditions, prior sale, lease or financing, or withdrawal without notice. We include projections, opinions, assumptions or estimates for example only, and they may not represent current or future performance of the property. You and your tax and legal advisors should conduct your own investigation of the property and transaction.

1155 S Telshor Blvd  
Las Cruces, NM 88011  
(575) 521 - 1535  
1stvalley.com



# 16065 US-70

**NAI 1st Valley**  
Commercial Real Estate Services, Worldwide.

## Additional Photos



We obtained the information above from sources we believe to be reliable. However, we have not verified its accuracy and make no guarantee, warranty or representation about it. It is submitted subject to the possibility of errors, omissions, change of price, rental or other conditions, prior sale, lease or financing, or withdrawal without notice. We include projections, opinions, assumptions or estimates for example only, and they may not represent current or future performance of the property. You and your tax and legal advisors should conduct your own investigation of the property and transaction.

1155 S Telshor Blvd  
Las Cruces, NM 88011  
(575) 521 - 1535  
[1stvalley.com](http://1stvalley.com)



# 16065 US-70

## Aerial View



## Distance to Las Cruces

14.4 Miles

21 Minute Drive Time

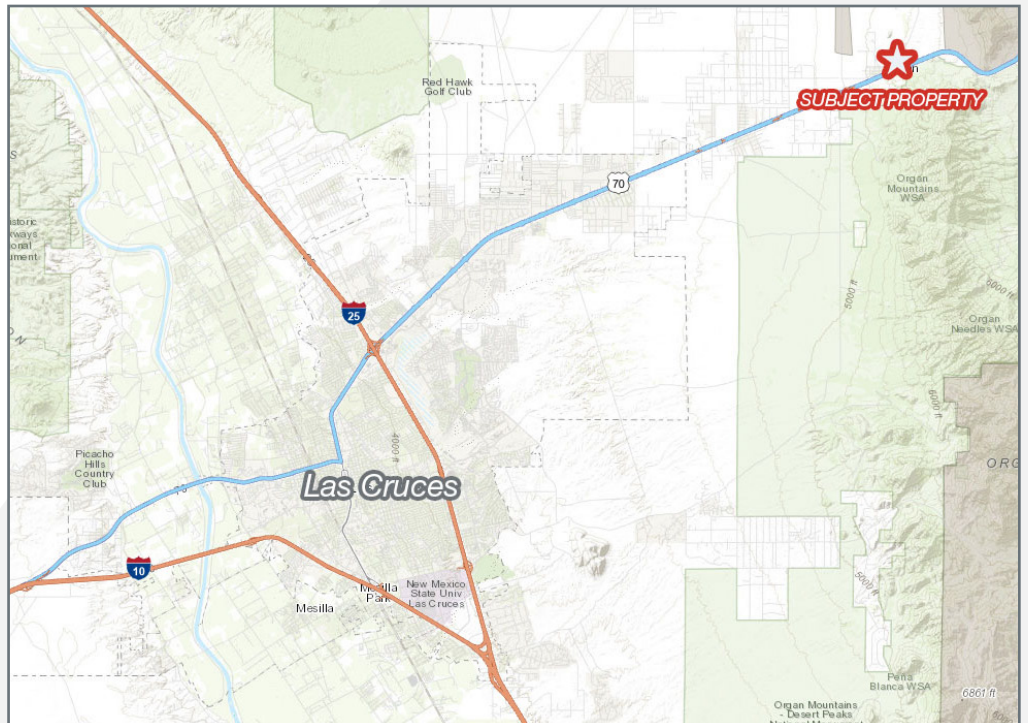

For more information:

**Preston Williams**

O: 575.521.1535 C: 575.621.2445

preston@1stvalley.com

We obtained the information above from sources we believe to be reliable. However, we have not verified its accuracy and make no guarantee, warranty or representation about it. It is submitted subject to the possibility of errors, omissions, change of price, rental or other conditions, prior sale, lease or financing, or withdrawal without notice. We include projections, opinions, assumptions or estimates for example only, and they may not represent current or future performance of the property. You and your tax and legal advisors should conduct your own investigation of the property and transaction.

1155 S Telshor Blvd  
Las Cruces, NM 88011  
(575) 521 - 1535  
1stvalley.com