

For Lease

Office/Warehouse | 5,000 ± SF



1815 Copper Loop

Las Cruces, NM 88011

Offering Summary

Lease Rate	\$3,300/month (NNN)
-------------------	---------------------

Warehouse Size	4,616 ± SF
-----------------------	------------

Office Size	384 ± SF
--------------------	----------

Property Highlights

- Total Space Available: 5,000 ± SF
- Dimensions: 50' x 100'
- Zoning: M1
- Clear height: 17'
- Two (2) 12' x 12' grade roll up doors
- Two (2) ADA bathrooms
- Fenced yard space

For more information:

Jacob Slavec, SIOR

O: 575.521.1535 C: 575.644.8529
jacob@1stvalley.com

Cheryl Reome

O: 575.521.1535 C: 575.644.9165
cheryl@1stvalley.com

Interior Floor Plan

** Not to scale. For visual aid purposes only.*

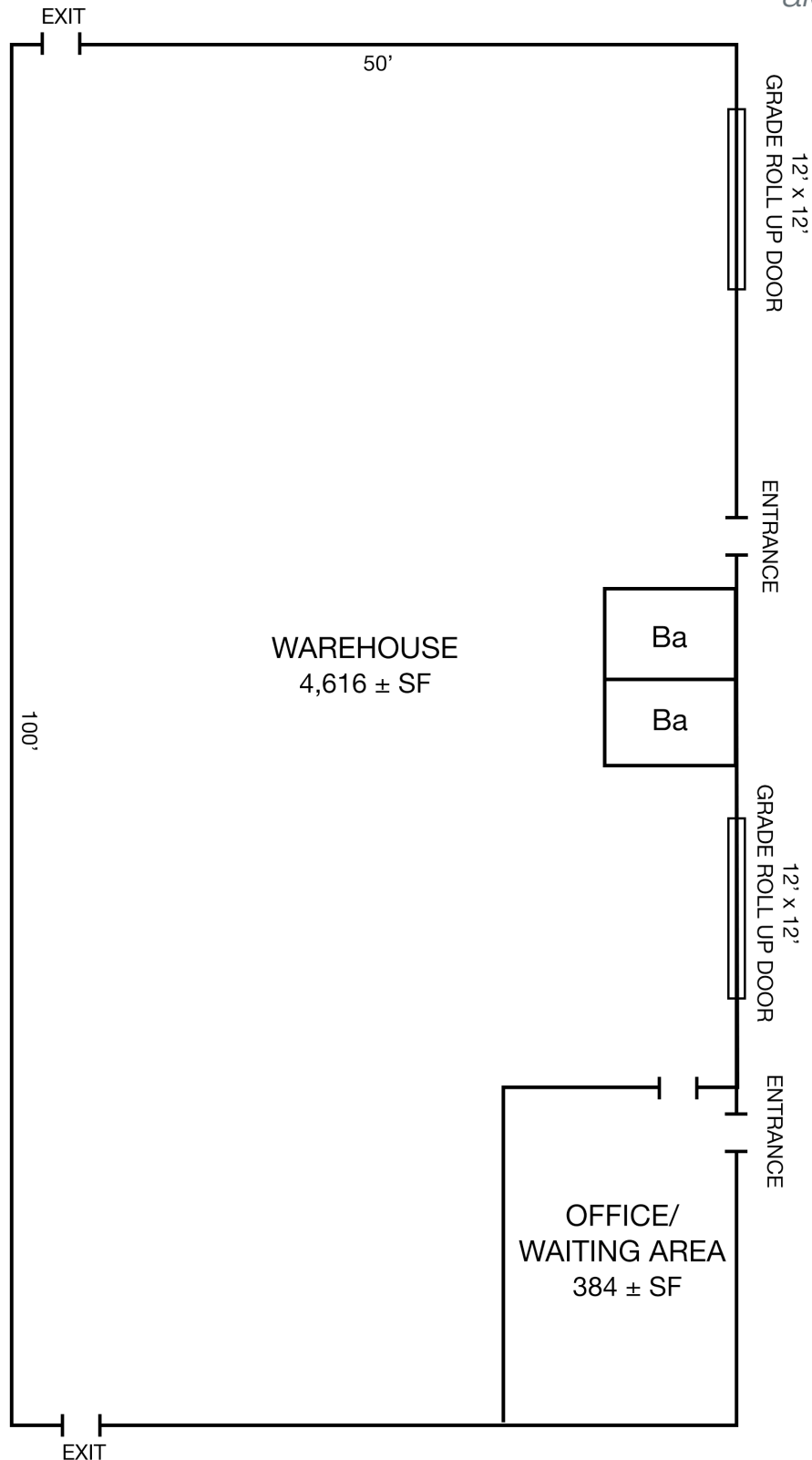

1815 Copper Loop

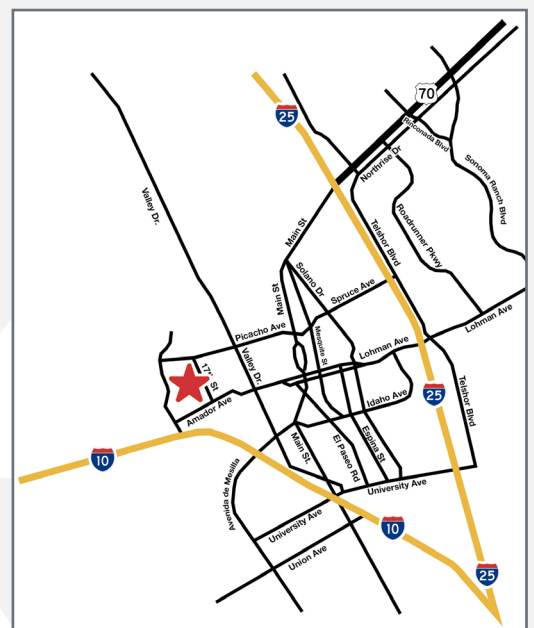

We obtained the information above from sources we believe to be reliable. However, we have not verified its accuracy and make no guarantee, warranty or representation about it. It is submitted subject to the possibility of errors, omissions, change of price, rental or other conditions, prior sale, lease or financing, or withdrawal without notice. We include projections, opinions, assumptions or estimates for example only, and they may not represent current or future performance of the property. You and your tax and legal advisors should conduct your own investigation of the property and transaction.

1155 S Telshor Blvd
Las Cruces, NM 88011
(575) 521 - 1535
1stvalley.com